

Omega Design's

LCX 2

Rotary Pocket Bottle Unscrambler

The Right Choice for Speed, Reliability, and Value.



- 100% positive control of the bottle
- Advanced controls package
- Open design for easy access and cleaning
- Rapid, repeatable changeovers
- Accommodates wide range of bottles

300+

Bottles per minute



Changeover



Full Bottle Control



30cc
to
1500cc

Ideal applications: bottles, jars, tubes, vials, other

** Speed and changeover will vary per customer's application and options selected.*

★★★★★
MADE IN THE USA

Since 1969

www.omegadesign.com

Tel: 1 (610) 363-6555

OMEGA
DESIGN CORPORATION

LCX 2

Rotary Pocket Bottle Unscrambler

Our Value Promise
www.omegadesign.com/value



Ask Us About OMEGA'S **IMPACT Series** OF PACKAGING EQUIPMENT

- Low cost machine configurations
- Save 20-40% on this machine
- Get faster lead times (6-10 weeks)

UTILITIES:

- Voltage: 208/240/480 VAC, 50/60 Hz
- Air: 8-24 SCFM @ 80 psig
- Utilities may vary per client specifications

CONTROLS:

- Allen Bradley PLC
- Allen Bradley Touch Screen HMI
- Allen Bradley AC Motor With VFD

SPEED:

- Up to 300 bottles per minute

STANDARD FEATURES:

- Patented rotary pockets for positive bottle control
- 30 cu.ft. hopper with elevator
- Jam-prevention package (paddlewheel, air jets)
- Leveling legs
- Lubed-for-Life bearings
- Electrical safety Interlocks
- Steel frame with painted protective coating

OPTIONS:

Ionized Air Rinsing Ink & Laser Coding Inspection & Data Management Reject Handling

Desiccant Insertion Glass Processing Brite Stock Processing Secondary Orientation

ADDITIONAL OPTIONS:

- Hopper upgrades
- Discharge conveyor and Down Bottle Reject System
- Adjustable and toolless change parts
- Class 100 Clean Room packages
- UL panel
- Validation support documentation

OPERATION:

An operator loads empty bottles into the standalone hopper. An elevator transports the bottles to the sorter. Bottles exit through a chute. At the base of the chute, a mechanical 'hand', or rotary pocket, gently grips a bottle for additional processing and/or final orientation. The rotary pocket discharges the bottle onto a conveyor.

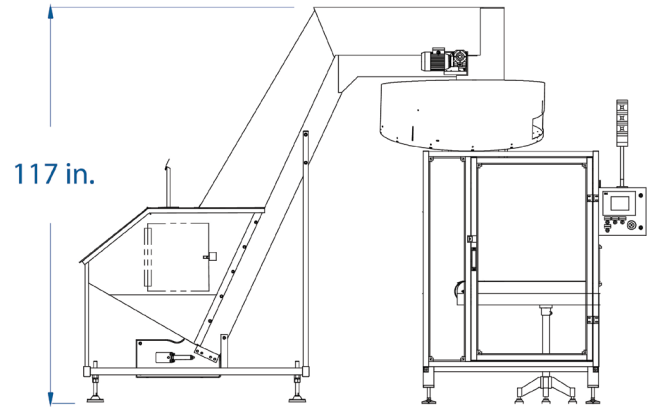
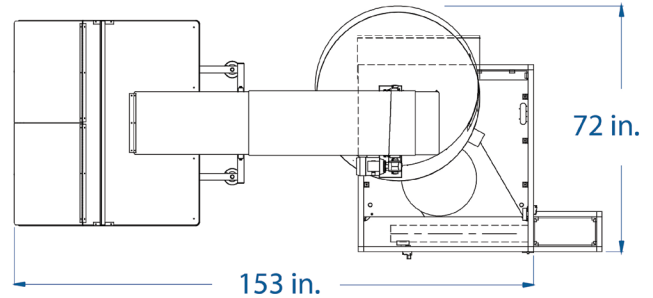
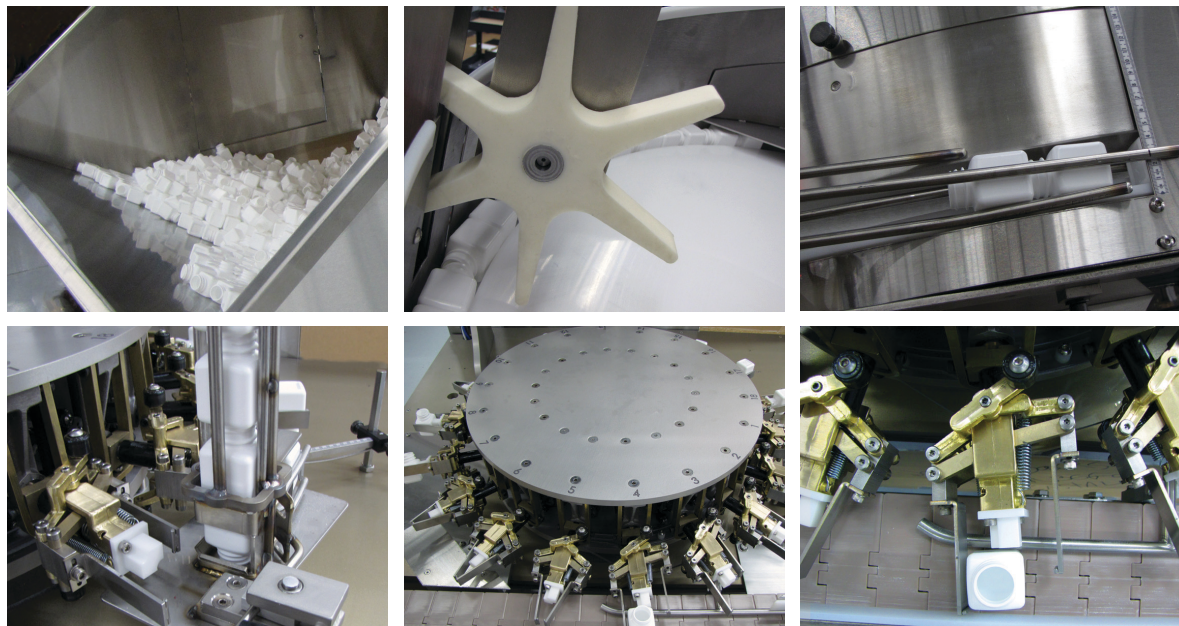

* Layout and dimensions may vary per application.

Reminder Ask about our excellent track record of on-time deliveries and industry-leading FATs. Better yet, read what our clients have to say: www.omegadesign.com/testimonials

