

Omega Design's

PRP

Bottle Unscrambler with Puck Handling System

Discover High Speed, Trouble-Free Unscrambling that Places a Bottle in Every Puck



- 100% positive control of the bottle
- Handles many complex bottle shapes
- Various infeed configurations available
- Open design for easy access and cleaning
- Rapid, repeatable changeovers

300

Bottles per minute



Changeover



Full Bottle Control



30cc
to
1500cc

Ideal applications: bottles, tottles, jars, tubes, vials, other

** Speed and changeover will vary per customer's application and options selected.*

★★★★★
MADE IN THE USA

Since 1969

www.omegadesign.com

Tel: 1 (610) 363-6555



UTILITIES:

- Voltage: 208/240/480 VAC, 50/60 Hz
- Air: 8-24 SCFM @ 80 psig
- Utilities may vary per client specifications

CONTROLS:

- Allen Bradley PLC
- Allen Bradley Touch Screen HMI
- Allen Bradley AC Motor With VFD

SPEED:

- Up to 300 pucks per minute

STANDARD FEATURES:

- Patented rotary pockets for positive bottle control
- Various puck infeed configurations to fit most line layouts
- Pneumatic tamper to assist bottle placement in puck
- Puck infeed screw
- 30 cu.ft. hopper with elevator
- Leveling legs
- Lubed-for-Life bearings
- High efficiency air nozzles
- Electrical safety Interlocks
- Steel frame with painted protective coating

OPTIONS:

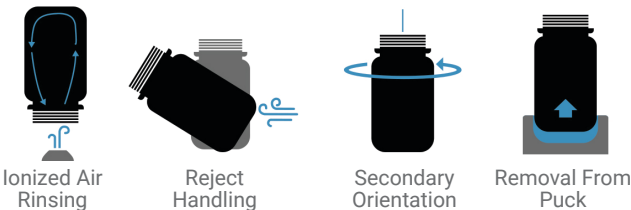

- Hopper upgrades
- Adjustable and toolless change parts
- Frame upgrade to stainless steel
- Puck return system
- UL panel
- Validation support documentation

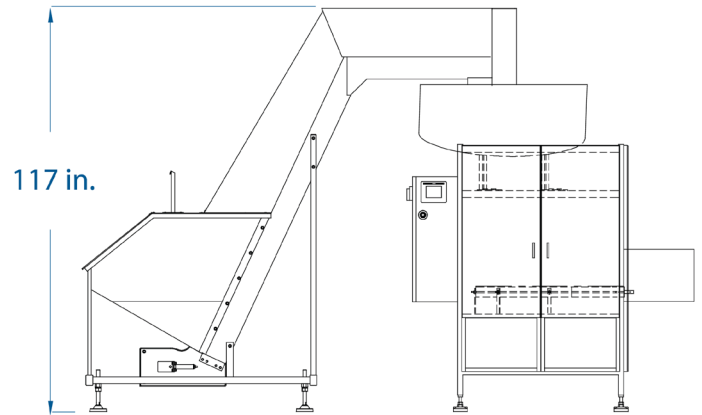
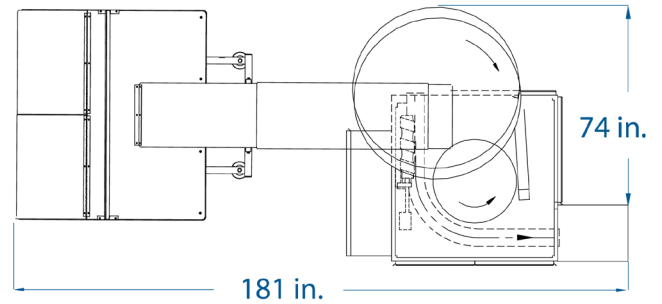

* Layout and dimensions may vary per application.

OPERATION:

An operator loads empty bottles into the standalone hopper. An elevator transports the bottles to the sorter. Bottles exit into a vertical chute. At the base of the chute, a mechanical 'hand', or rotary pocket, gently grips each bottle for additional processing. Empty pucks enter the side of the machine. Each puck engages the feed screw and starwheel to become vertically aligned with a rotary pocket. Once aligned, the rotary pocket releases the bottle. An overhead pneumatic tamper taps the top of the bottle to ensure it is securely positioned in the puck.



Ask us about our Puck Design and Puck Procurement Services

Reminder Ask about our excellent track record of on-time deliveries and industry-leading FATs. Better yet, read what our clients have to say: www.omegadesign.com/testimonials